



Dell PH45W17-BA Hybrid Adapter + Power Bank

User's Guide

Regulatory model: PHA45W17-BA



Notes, Cautions, and Warnings

-  **NOTE:** A NOTE indicates important information that helps you make better use of your power hub.
-  **CAUTION:** A CAUTION indicates potential damage to hardware or loss of data if instructions are not followed.
-  **WARNING:** A WARNING indicates a potential for property damage, personal injury, or death.

Copyright © 2017 Dell Inc. All rights reserved. This product is protected by U.S. and international copyright and intellectual property laws.

Dell™ and the Dell logo are trademarks of Dell Inc. in the United States and/or other jurisdictions. All other marks and names mentioned herein may be trademarks of their respective companies.

Contents

About your power hub	5
Product features	5
What's in the box	6
Features	7
Power adapter	7
Power bank	7
Attaching the ferrite core	8
Charging your power bank	9
Charging your device	11
Charging your laptop.	11
Charging your mobile devices	12
Disconnecting the power adapter from your power bank .	13
Alternative charging methods.	14
Charging your laptop using the power adapter	14
Charging your laptop using the power bank	15
Charging your devices using the power hub	16
Checking the battery	17
Checking battery-charge status.	17
Checking the battery health.	18
Error status.	18
Attaching the ferrite core	

- Troubleshooting19
 - Common symptoms 19
- Specifications 20
 - General20
 - Physical characteristics20
 - Interfaces/Ports20
 - Environmental20
- Statutory information21
 - Warranty 21
 - Limited warranty and return policies 21
 - For U.S. customers:21
 - For European, Middle Eastern and African customers:21
 - For non-U.S. customers:21

About your power hub

Product features

The features of the **Dell power hub PH45W17-BA** include:

Portability

You could use your power hub to charge your Dell laptop or mobile devices while on-the-go.

Compliance

Suitable for devices compliant with USB battery charging specification, Revision 1.2 (BC1.2).

Compact design

Small in size and ideal to be placed in pockets or bags.

What's in the box

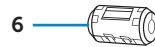
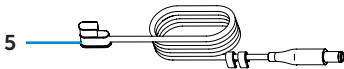
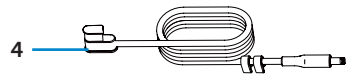
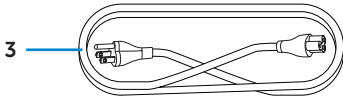
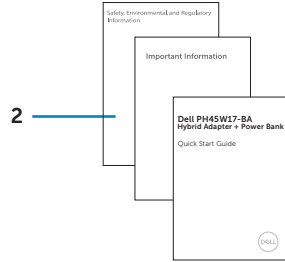
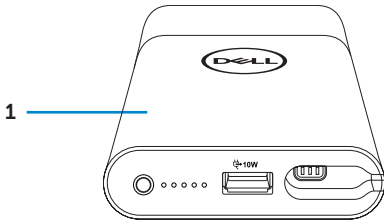

1 Power hub

3 Power cord

5 Power-out cable (7.4mm)

2 Documents

4 Power-out cable (4.5mm)

6 Ferrite core

Features

Power adapter

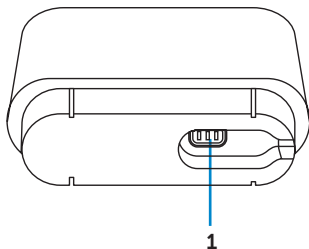

Power bank

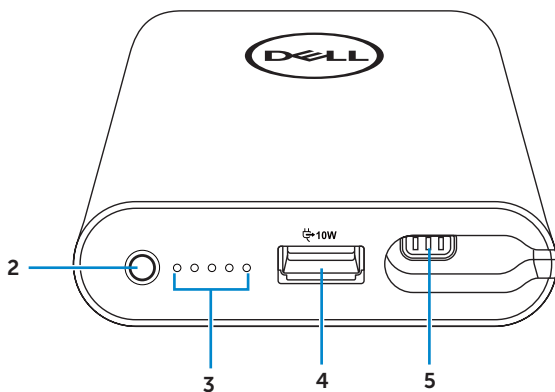

- | | | | |
|---|--------------------------------|---|------------------------------------|
| 1 | Power-out port (to power bank) | 2 | Power button/Battery-status button |
| 3 | Battery-status lights (5) | 4 | USB-out port |
| 5 | Power-out port (to laptop) | | |

Attaching the ferrite core

In order to reduce electromagnetic interference, attach the supplied ferrite core to the power-output cable connected to your laptop.

- 1 Open the the ferrite core.
- 2 Clamp the core around the power-output cable as shown in the illustration.

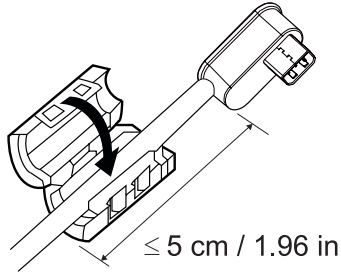

- 3 Close the ferrite core, snapping the small latches back together.

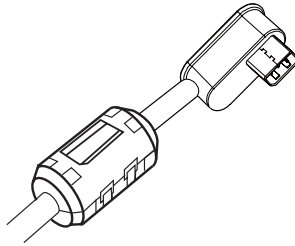

Charging your power bank

 **WARNING: To avoid injury and damaging your device, use only the power cord that was shipped with your power bank.**

Before first use, charge the power bank using the power cord.

 **NOTE:** It takes approximately three hours to fully charge the power bank.

 **NOTE:** You can charge your devices through the power bank while the power bank is getting charged.

 **NOTE:** The power cable is shipped with the power bank.

- 1 Attach the power cord to the power hub.
- 2 Connect the power cord to an electrical outlet.
 - The battery-status light turns flashing white indicating that the battery is getting charged. See **Checking battery charge status** for details.
 - The battery-status lights turn off when the battery is fully charged or when the power cable is disconnected.

- NOTE: If the amber battery-status light flashes while the battery is charging, this indicates a charging error. Check if you have firmly attached the power adapter to the power bank.
- NOTE: For more information on battery-status lights, see **Checking battery charge status**.

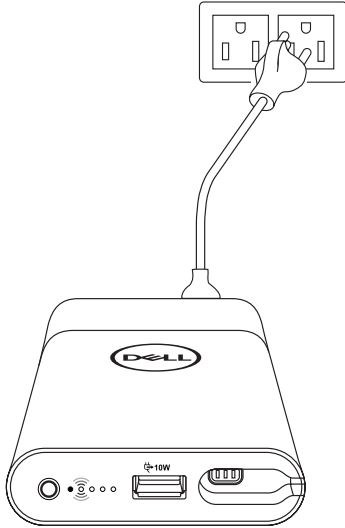

Proper removal of the power cable

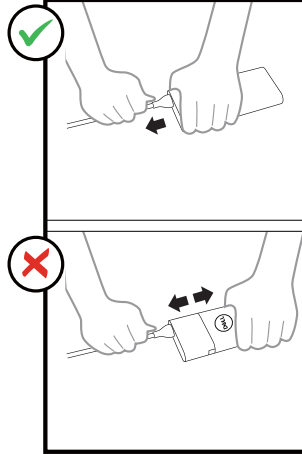

Charging your device

Charging your laptop

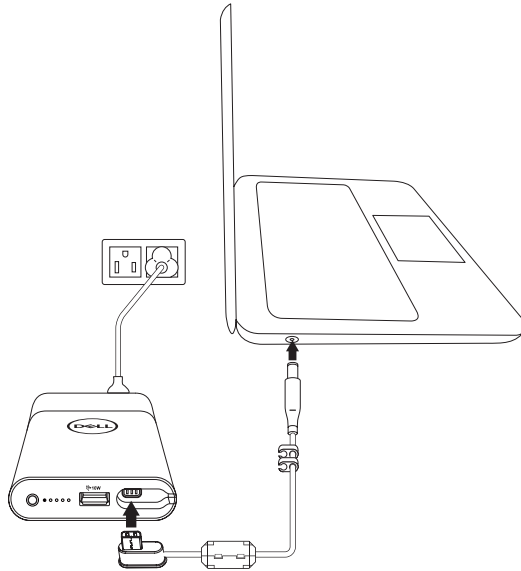

- 1 Connect the power cable to the power hub.
- 2 Connect the power cable to an electrical outlet.
- 3 Connect one end of the power-out cable to the power-out port on the power bank.
- 4 Connect the other end of the power-out cable to the power-adapter port on your laptop.

Charging your mobile devices

Using the power bank, you can charge up to two portable devices simultaneously.

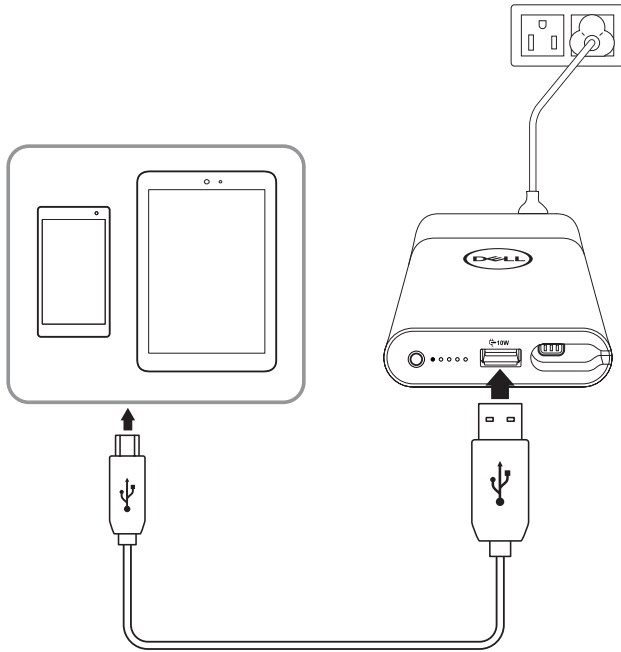

- 1 Connect the power cable to the power hub.
- 2 Connect the power cable to an electrical outlet.
- 3 Connect one end of the USB cable to the USB port on the power bank.
- 4 Connect the other end of the USB cable to the charging port on your mobile device.

 **NOTE:** Use the USB cable that came with your mobile device.

Disconnecting the power adapter from your power bank

The power bank and power adapter can work independently to charge your devices.

1 Firmly press the two latches on the power adapter.

Proper power adapter removal

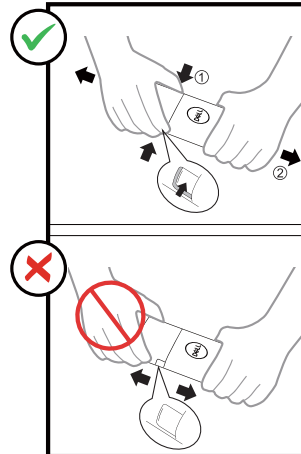
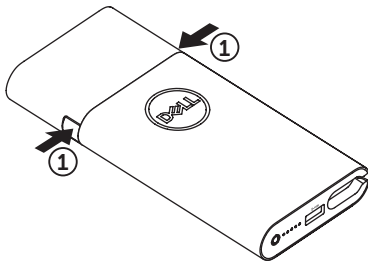

2 While holding onto the latches, pull the power adapter away from the power bank. The power bank and power adapter can now be used separately.

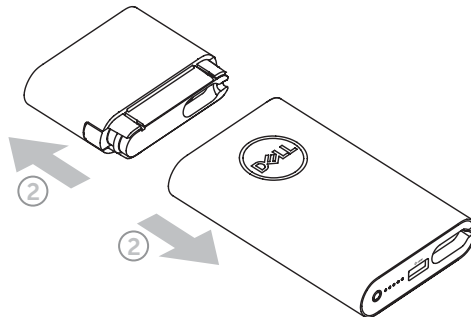

Alternative charging methods

You can charge your devices by either using the power bank or power adapter independently. Using the power hub, you can charge up to two devices simultaneously.

Charging your laptop using the power adapter

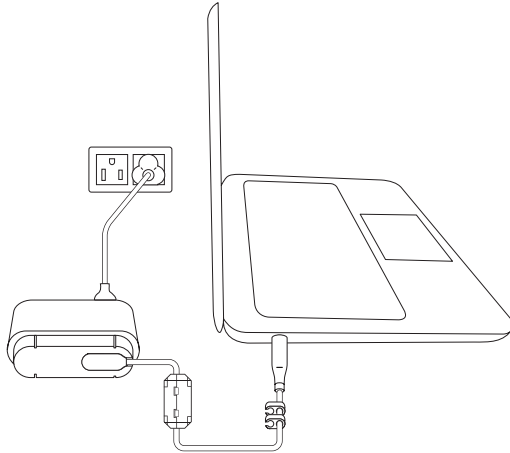

- 1 Connect the power cable to the power adapter.
- 2 Connect the power cable to an electrical outlet.
- 3 Connect one end of the power-out cable to the power-out port on the power adapter.
- 4 Connect the other end of the power-out cable to the power-adapter port on your laptop.

Charging your laptop using the power bank

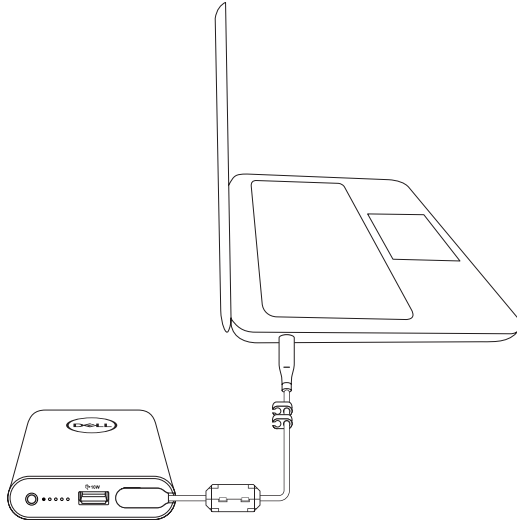

- 1 Connect one end of the power-out cable to the power-out port on the power bank.
- 2 Connect the other end of the power-out cable to the power-adapter port on your laptop.

 NOTE: The battery-status light turns amber when the power bank battery is low.

Charging your devices using the power hub

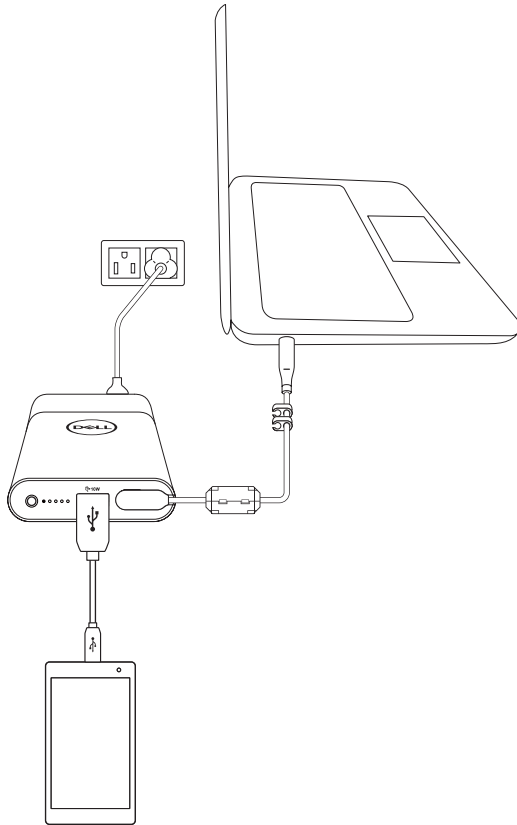

- 1 Connect the power cable to the power adapter.
- 2 Connect the power cable to an electrical outlet.
- 3 Connect one end of the power-out cable to the power-out port on the power hub.
- 4 Connect the other end of the power-out cable to the power-adaptor port on your laptop.
- 5 Connect one end of the USB cable to the USB port on the power hub.
- 6 Connect the other end of the USB cable to the charging port on your mobile device.

Checking the battery

Checking battery-charge status

Press the power button to check the battery status of the power bank. The battery-status lights turn on indicating the battery-charge status of the power bank.

 **NOTE:** The battery-status lights remain illuminated for 5 seconds after you release the power button.

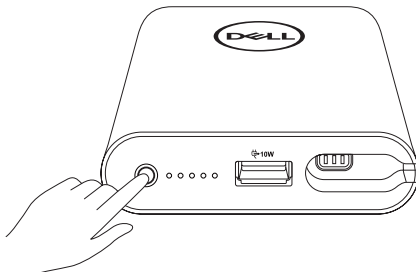

Battery-status light	LED color and behavior	Battery capacity status
All 5 battery-status lights are off ● ● ● ● ●	Off	100%
All 5 battery-status lights are on ○ ○ ○ ○ ○	White (solid)	81% – 99%
1 st -4 th battery-status lights are on ○ ○ ○ ○ ●	White (solid)	61% – 80%
1 st -3 rd battery-status lights are on ○ ○ ○ ● ●	White (solid)	41% – 60%
1 st -2 nd battery-status lights are on ○ ○ ● ● ●	White (solid)	21% – 40%
1 st battery-status light is on ○ ● ● ● ●	White (solid)	11% – 20%
1 st battery-status light is on ● ● ● ● ●	Amber (solid)	1-10% (battery low state)

 **NOTE:** All five battery-status lights turn off when the battery is fully charged.

Checking the battery health

Battery health is a measurement reflecting the general condition of the battery. It indicates how much battery life remains before the power bank must be replaced.

 **NOTE:** The units of SOH (State Of Health) are percentage (%) points.

A battery's SOH is 100% at the time of manufacture and will deteriorate gradually with usage.

Press and hold the power button for five seconds to turn on the power bank then check the battery health status.

Battery-status light	Battery health status
5 th battery-status light is on ● ● ● ● ○	81% – 100%
4 th & 5 th battery-status lights are on ● ● ● ○ ○	61% – 80%
3 rd ~5 th battery-status lights are on ● ● ○ ○ ○	41% – 60%
2 nd ~5 th battery-status lights are on ● ○ ○ ○ ○	21% – 40%
All 5 battery-status lights are on ○ ○ ○ ○ ○	1% – 20%

Error status

The types of error conditions are shown in the table below.

Event	Battery-status light color and behavior	Status
All modes	One second flash ON/OFF interchangeably on the 1 st battery-status light (amber) and 2 nd battery-status light (white)	High temperature
PSID Fail or Daisy Chain	Flashing amber	Error caused by improper connection or damaged power adapter.

Troubleshooting

Common symptoms

The following table contains information about common issues you might encounter and the possible solutions.

Common symptoms	Possible solutions
The power hub gets unusually hot when placed inside the pocket/bag.	<ul style="list-style-type: none">• Unplug the power output cable immediately.• Take the power hub out of your pocket/bag immediately. Then let it cool down.
The power bank battery power gets drained too fast.	When connecting to a mobile device, close applications you are not using or set the device to airplane mode.
The battery-status light does not light up.	<ul style="list-style-type: none">• Check if the power bank is out of battery power. Charge the power bank.• If the problem persists, contact Dell or your dealer for technical assistance.

Specifications

General

Model number	PH45W17-BA (4-cell, 43Wh)
Supported output	19.5 V; 2.3 A 5 V, 1.5 A
USB output	5 V, up to 2.1 A
LED	5 battery-status lights

Physical characteristics

Weight	425g (0.93lb)
Dimension (L x W x H)	173 x 78 x 22.5 mm (6.81 x 3.07 x 0.88in)
Cord length	914 mm (35.98in) (Power cord) 1250 mm (49.21in) (Power-out cable)

Interfaces/Ports

Input	One Power-in port (male)
Output	One Dell proprietary connector (female) One USB port (battery charging 1.2 compliant)

Environmental

Temperature	Operating: 0°C to 40°C (32°F to 104°F) Storage: -20°C to 60°C (-4°F to 140°F)
Humidity	90% maximum relative humidity; non-condensing

Statutory information

Warranty

Limited warranty and return policies

Dell-branded products carry a 1-year limited hardware warranty.

WARNING

IMPORTANT SAFETY INSTRUCTIONS

INSTRUCTIONS PERTAINING TO RISK OF FIRE OR INJURY TO PERSONS

- Do not expose to moisture or hot climates for extended period of time.
- Do not operate in an enclosed environment (e.g. bag or area with poor ventilation).
- Do not disassemble, puncture, drop or submerge in liquid.
- If bulging or bubbling develops, discontinue use immediately.
- Not for children under three years old.

FOLLOW AND SAVE THE INSTRUCTIONS!

For U.S. customers:

This purchase and your use of this product are subject to Dell's end user agreement, which you can find at <http://www.dell.com/terms>. This document contains a binding arbitration clause.

For European, Middle Eastern and African customers:

Dell-branded products that are sold and used are subject to applicable national consumer legal rights, the terms of any retailer sale agreement that you have entered into (which will apply between you and the retailer) and Dell's end user contract terms.

Dell may also provide an additional hardware warranty – full details of the Dell end user contract and warranty terms can be found by going to

<http://www.dell.com>, selecting your country from the list at the bottom of the “home” page and then clicking the “terms and conditions” link for the end user terms or the “support” link for the warranty terms.

For non-U.S. customers:

Dell-branded products that are sold and used are subject to applicable national consumer legal rights, the terms of any retailer sale agreement that you have entered into (which will apply between you and the retailer) and Dell's warranty terms. Dell may also provide an additional hardware warranty – full details of Dell's warranty terms can be found by going to <http://www.dell.com>, selecting your country from the list at the bottom of the “home” page and then clicking the “terms and conditions” link or the “support” link for the warranty terms.